

### ⚠ WARNING

To prevent possible **SERIOUS INJURY** or **DEATH** from a moving gate or garage door:

- ALWAYS keep remote controls out of reach of children. NEVER permit children to operate, or play with remote controls.
- Activate gate or door **ONLY** when it can be seen clearly, is properly adjusted and there are no obstructions to door travel.
- ALWAYS keep gate or garage door in sight until completely closed. NEVER permit anyone to cross path of moving gate or door.



**WARNING:** This product can expose you to chemicals including lead, which are known to the State of California to cause cancer or birth defects or other reproductive harm. For more information go to [www.P65Warnings.ca.gov](http://www.P65Warnings.ca.gov).

Your remote control is designed for use with garage door openers manufactured starting January 1, 1993 that have a LEARN button.

*The images throughout this manual are for reference only and your product may look different.*

### BEFORE YOU START

Locate the LEARN button on the garage door opener, and then locate the program button on the remote control.

**IMPORTANT:** The remote will activate your door or gate during programming. Be sure the door is clear of ALL obstructions. Start with the garage door closed. Make sure the garage door opener has a working light because it is a programming indicator.

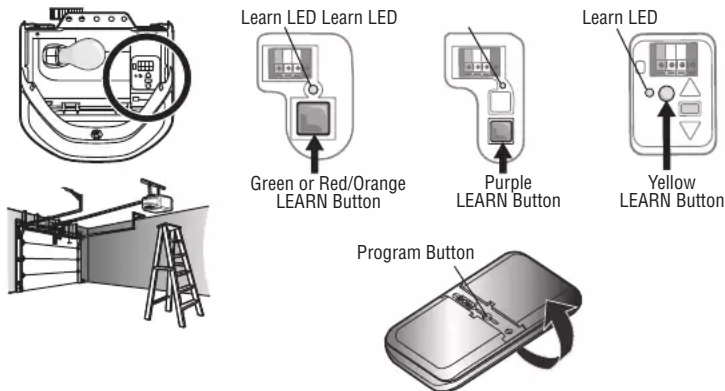

### PROGRAM TO GARAGE DOOR OPENERS WITH A YELLOW LEARN BUTTON

If your remote was previously programmed to another type of opener, follow the programming instructions for **PROGRAM TO ALL GARAGE DOOR OPENERS** below to reprogram to a yellow LEARN button.

1. Start with the garage door closed.
2. Press and immediately release the yellow LEARN button. The Learn LED glows steady for 30 seconds. Within 30 seconds...

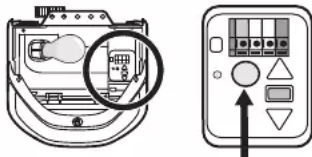

1. Press and hold the button on the remote control.



2. Release the button when the garage door opener lights blink or two clicks are heard.
3. Test by pressing the button you just programmed. The opener activates.

### PROGRAM TO ALL GARAGE DOOR OPENERS

1. Press and hold the program button with the visor clip until the LED on the front of the remote control turns on.

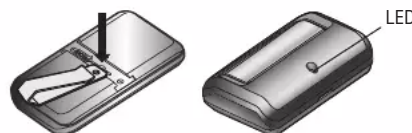

2. Press and release the remote control button the number of times that corresponds with the garage door opener type. **NOTE:** Make sure the LED stops flashing between each press of the button.



| # of Presses | Garage Door Opener Type                                  |
|--------------|--|
| 1            | Yellow LEARN Button (Security+ 2.0 <sup>®</sup> )        |
| 2            | Purple LEARN Button (315MHz Security+ <sup>®</sup> )     |
| 3            | Red/Orange LEARN Button (390MHz Security+ <sup>®</sup> ) |
| 4            | Green LEARN Button (390MHz Billion Code)                 |

3. Press the program button with the visor clip until the LED on the front of the remote turns off.
4. Choose from Options A, B, C, or D to complete programming.

### Option A: Program Using the Push Button Door Control

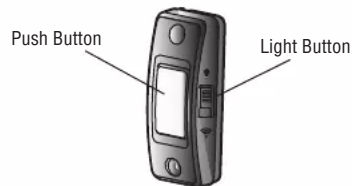

5. Press and hold the light button and the push button until the push button LED begins to blink.
6. Press and hold the button on the remote until the garage door lights blink or two clicks are heard. Release the button. Programming is complete.
7. Test by pressing the button you just programmed. The opener activates.